

SHELCO FILTERS - MODELS RHB & RHS

INSTALLATION, OPERATION, MAINTENANCE MANUAL

WARNING:

The filter must be protected from freezing to prevent cracking, which would result in leakage.

MAXIMUM OPERATING PRESSURE
300 PSI (20.7 BAR) @ 200 °F (93 °C)

INSTALLATION

A recommended installation is shown below with inlet, outlet, and bypass valves to isolate the housing for ease of changing cartridges. Also recommended is the installation of union couplings on either side of the filter to facilitate installation and removal of the housing. Ensure that the direction of flow indicated by the arrow on the head is consistent with your process. **DO NOT INSTALL BACKWARDS.** If your housing is equipped with gauge ports, install suitable pressure gauges. Otherwise, it is recommended that pressure gauges be installed in the inlet and outlet piping as an indicator of remaining cartridge life.

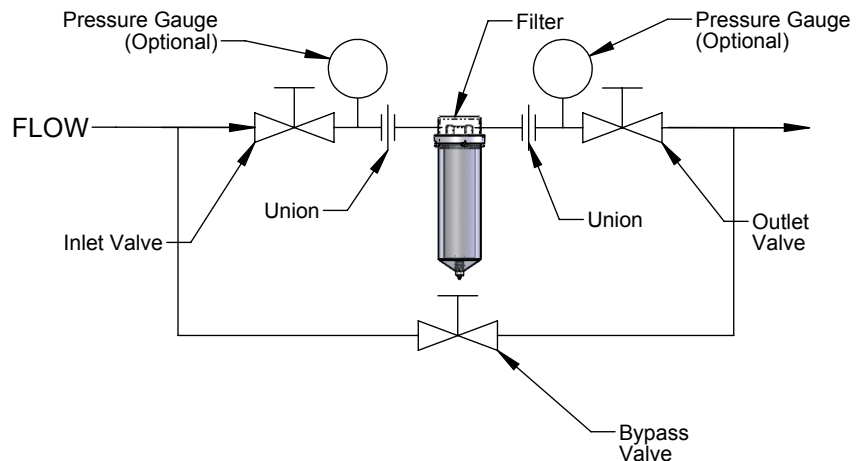
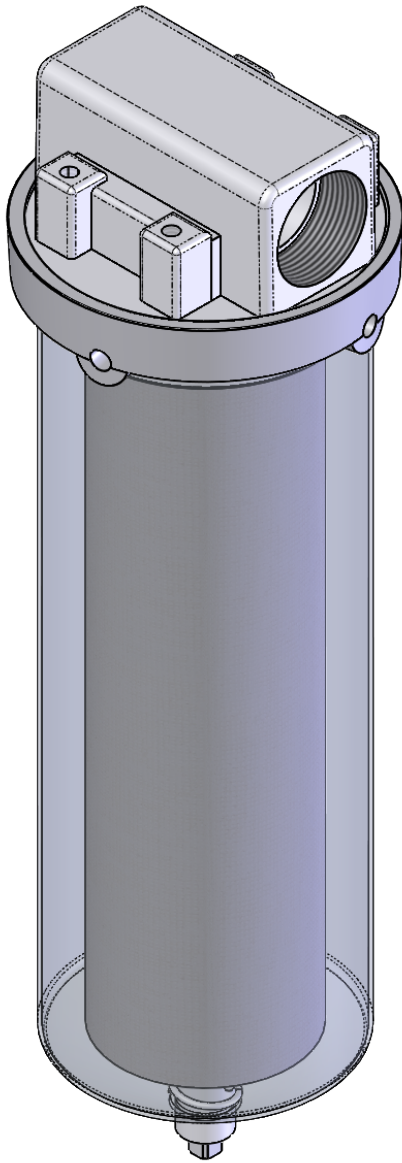

CARTRIDGE INSTALLATION OR REPLACEMENT (See exploded view on other side)

1. Close inlet and outlet valves and open the bypass valve. Open drain and allow sump to drain.
2. Loosen the ring nut and slide it down the sump. Remove the sump from the head.
3. Check the shell gasket for damage. Replace if necessary.
4. Remove old cartridge and clean the inside of the sump. Insert the new cartridge, making sure it seats properly on the seal plate at the bottom of the sump.
5. Lubricate the gasket to prevent binding or pinching during installation.
6. Reassemble the sump to the head. Slide the ring nut up to the head and tighten until it is snug, then another 1/8 to 1/4 turn. Do not overtighten. Close the drain at the bottom of the sump.
7. Open inlet and outlet valves and close the bypass valve. If a leak appears, close the inlet and outlet and open the drain to relieve the pressure. Loosen the ring nut and repeat steps 5, 6, and 7 above to adjust alignment and gasket seating. If the leak persists, check the gasket for damage and replace as necessary.

SHELCO FILTERS - MODELS RHS & RHB

INSTALLATION, OPERATION, MAINTENANCE MANUAL

MAINTENANCE

Shelco filters generally require very little maintenance. The filter element should be replaced when the pressure drop across the filter reaches a maximum of 20 PSI. Your experience might dictate more frequent cartridge replacement. The gasket should be inspected and replaced if necessary at the time the cartridge is replaced.

RECOMMENDED SPARE PARTS NUMBERS PER MATERIALS OF CONSTRUCTION			
		RHS	RHB
ITEM	DESCRIPTION	316 S.S.	304 S.S. & BRASS
1	HEAD*	2032-S*	2034-B*
2	RING NUT	3043-S	3043-B
3	GASKET**	3101-B	3101-B
4	DRAIN	PLUG 2103-S-316	PETCOCK 2088-4
5	SUMP+	RH-L-316	RH-L
6	DOE CARTRIDGE	CONSULT FACTORY	

* FNPT connection size code suffix as follows: 4=1/2"; 6=3/4"; 8=1"

** Standard gasket material is Buna N for temperatures up to 180 °F. Consult Shelco regarding your specific application.

+ Sump length code (L) per cartridge length as follows:
38=5"; 78=9 3/4"; 80=20"; 90=30"

Limited Warranty

Seller warrants each of the products described herein, under normal use and service, and subject to the user's compliance with these and any other operating instructions and directions given by the seller to be free from defects in materials or workmanship for a period of one year from date of shipment from seller's plant. Seller's liability under this warranty shall be limited to repairing or replacing any such defective products, at the seller's option, FOB seller's plant in Middletown, CT and reimbursing purchaser's shipping costs subject to the following: (1) timely receipt of purchaser's written notice that such products are defective; (2) seller's written authorization to purchaser for the return of such products to seller with shipping charges prepaid, and (3) seller's inspection of and confirmation that such products are defective in materials or workmanship.

If seller's inspection shows that the products returned are defective due to dirt, rust, or any foreign material not attributable to seller, improper usage, over-tightening of threads, abuse or incorrect reassembly in the field or other cause not due to seller's improper manufacture, seller will, subject to purchaser's written authorization, repair or replace such products at cost. Seller's factory inspection and testing will be made available to purchaser upon request.

THE WARRANTY IS IN LIEU OF ANY OTHER WARRANTY, EXPRESSED OR IMPLIED, INCLUDING ANY IMPLIED WARRANTY OF FITNESS OR MERCHANTABILITY. SELLER SHALL NOT BE LIABLE FOR ANY SPECIAL, INCIDENTAL OR CONSEQUENTIAL DAMAGES. NO REPRESENTATIVE OR SELLER HAS AUTHORITY TO MAKE ANY REPRESENTATIONS OR WARRANTIES EXCEPT AS STATED HEREIN.

Under no circumstances shall Seller be liable to Buyer or any third party for any loss of profits or other direct or indirect costs, expenses, losses or consequential damages arising out of or as a result of any defects in or failure of its products or any part or parts thereof or arising out of or as a result of parts or components incorporated in Seller's equipment but not supplied Seller.

The warranty excludes the following: A) Filter housings used for filtering brackish water, sea water, or where analysis shows TDS or Chlorides are in excess of 1,000 ppm; B) Gaskets and O-rings, once used; C) Altered products; D) Products without Seller's identification label.

It is the purchaser's responsibility to make certain the filter is compatible with all materials procured. Stainless Steel is not 100% non-corrosive. It is the purchaser's responsibility to complete a comprehensive water analysis (including Chlorides, TDS, and pH) to determine suitability of material. It is the purchaser's responsibility to inform seller of any application where TDS levels are in excess of 1,000 ppm, and/or where chlorides are in excess of 1000 ppm.



100 Bradley St. Middletown, CT 06457
Ph: 800.543.5843 Fax: 860.854.6120
www.shelco.com

